

## Device holder

### Mounting the device holder with tape

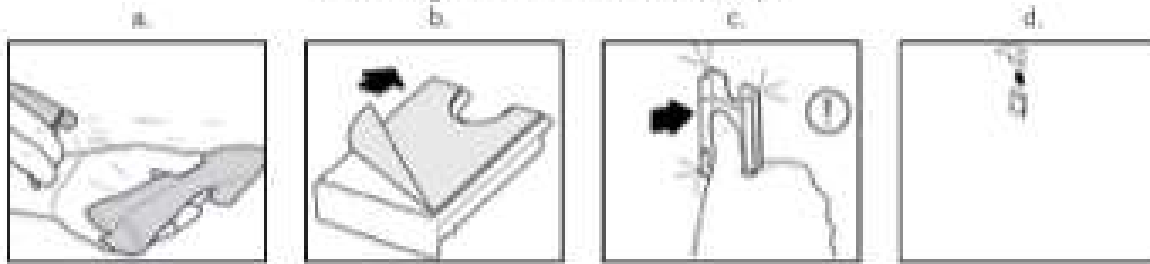

Clean the mounting surface and the rear side of the holder with a suitable cleaner (no moisturizing household cleaners) and a lint-free cloth, allowing it to dry thoroughly. Peel off the protective film from the adhesive strips, and using your thumb **firmly** press the rear side of the holder onto the cleaned surface. Wait **72 h** before first use. Slide the universal holder onto the rear side of the holder.

### Mounting the device holder in the benchtop rack

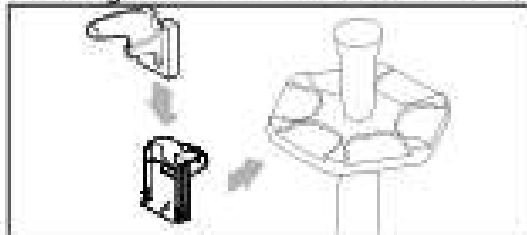

### Mounting the device holder to the edge of the racks



Clean the mounting surface and the rear side of the holder with a suitable cleaner (no moisturizing household cleaners) and a lint-free cloth, allowing it to dry thoroughly. Peel off the protective film from one side of the adhesive tape and stick it onto the rear side of the holder. Then peel off the protective film from the other side and stick the rear side of the holder onto the desired mounting edge. Using your thumb, press the rear side of the holder **firmly** onto the tape. Wait **72 h** before first use. Slide the universal holder onto the rear side of the holder.